

B-B(2:1)

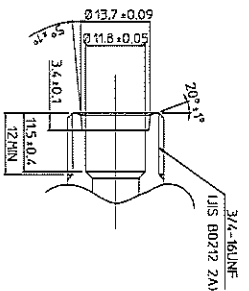

C-C(2:1)

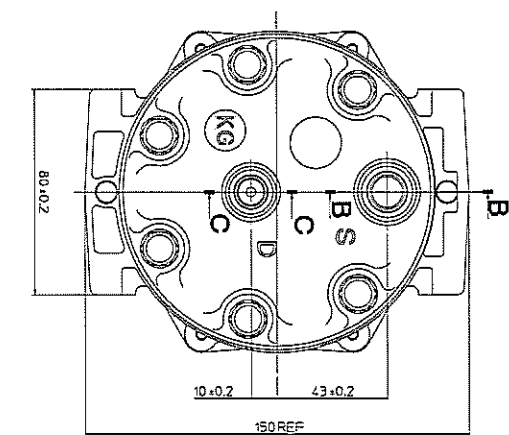
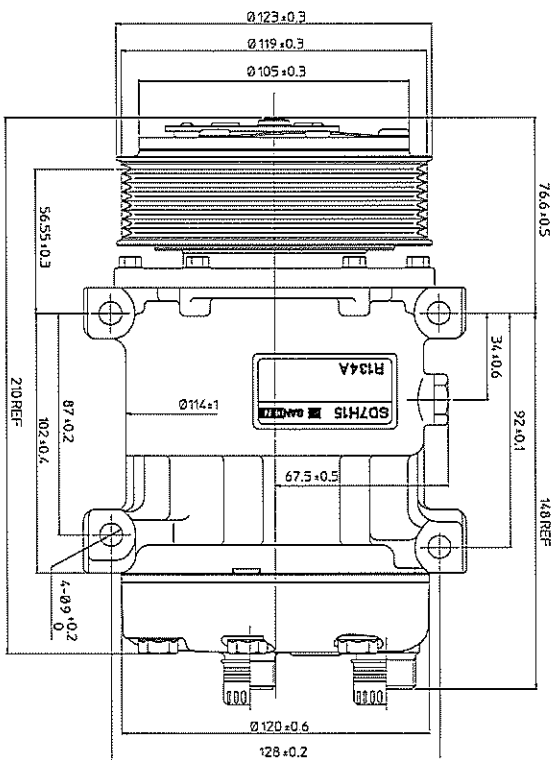

COMPRESSOR SPECIFICATIONS

CLUTCH SPECIFICATIONS

| | |
|----------------------------------|--------------|
| BORER | Ø29.3 mm |
| STROKE | 32.8 mm |
| DISPLACEMENT PER REVOLUTION | 151.9 cc/rev |
| NUMBER OF CYLINDERS | 7 |
| MAXIMUM ALLOWABLE CONTINUOUS RPM | 7000 rpm |
| MAXIMUM ALLOWABLE TORQUE | 6000 LCM |
| REFRIGERANT | HFC134a |
| OIL(S) (OR EQUIV) | H5 CC |
| ROTATION (CLUTCH SIDE VIEW) | CLOCKWISE |
| WEIGHT | kg |

| | |
|----------------------------------|-------------|
| RATED VOLTAGE | DC 24 V |
| BREAKAWAY TORQUE | 3.5 Kg-m |
| MINIMUM ENGAGEMENT TORQUE | 16 V max |
| POWER CONSUMPTION | 42 W (CU) |
| MAXIMUM ALLOWABLE CONTINUOUS RPM | 7000 r.p.m. |
| BEEL TYPE | EV |
| BEEL DIAMETER | Ø119mm |
| WEIGHT | kg |

These drawings or print contains proprietary and confidential information and is made available to the Recipient on expressed and specific conditions that neither it nor the information contained therein shall be disclosed or made available to any third party(ies) without the expressed and specific written consent of Sunden International (Singapore) Pte Ltd. These drawings or print shall not be copied or duplicated in any manner or to any extent without Sunden's prior expressed and specific written consent.



| | | | |
|-----|------|------|----------|
| NO. | DATE | REV. | REVISION |
| | | | |
| | | | |
| | | | |
| | | | |
| | | | |
| | | | |
| | | | |
| | | | |
| | | | |

COMPRESSOR

SD7H15KG6111
6111-6000S